

AERO FILLER CAPS

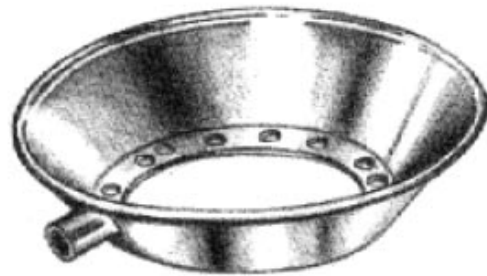

FUEL FILLER CAPS

Aero type flush fitting caps draw inspiration from fuel filler caps used on American WWII fighter aircraft. Popular with motorcycle manufacturers for many years, Ducati and others have incorporated these caps in their fuel tank designs. After being seen on the Ferrari F40, automotive concept and prototype car stylists quickly caught on to the idea. Aero caps now grace the flanks of the worlds leading exotics and supercars including the McLaren F1 and Jaguar XJ200. The design and finish of the cap are such that it is not always the appearance that attracts. The mechanism has a very pleasing feel with a precise action, as it should if incorporated on cars costing upward of a million dollars.

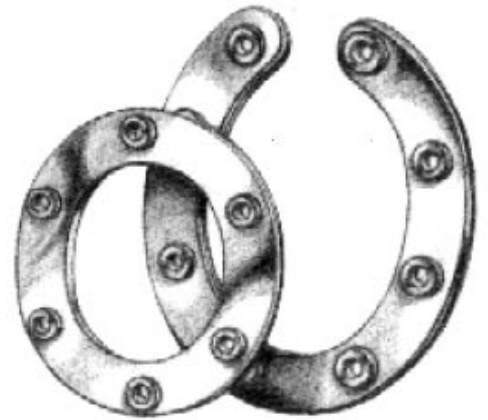
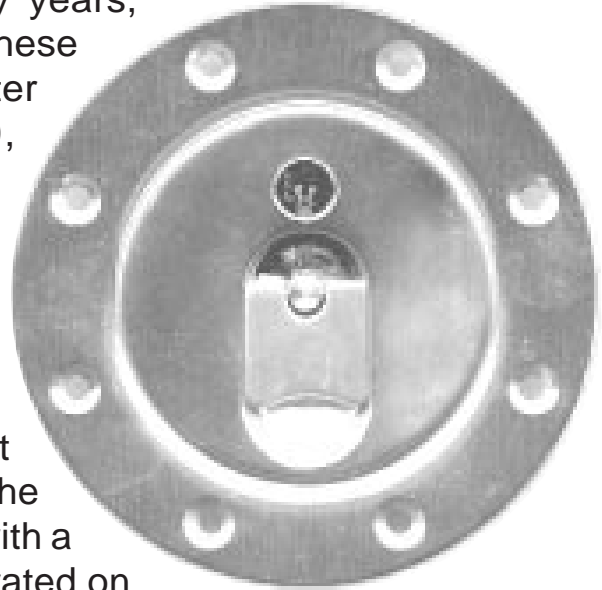

Construction The forged aluminum cap sits in a pressed aluminum flange sealed with a fuel resistant o-ring. Cap and flange are polished and anodized silver (colors available as special order).

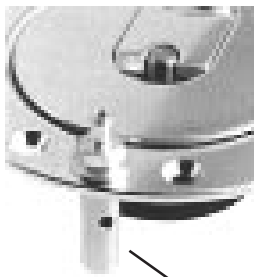

small vent valve

Caps are supplied with nuts, bolts, and fiber gasket. Locking version includes two keys.

Application Aero caps are designed for either direct to tank fitting or remote mounting to body work with connection to fuel tank through flexible hoses. To aid installation we can supply a variety of mounting flanges, funnels, fuel hose, and other assorted accessories. Caps are non-vented, however we can supply a small vent valve that can be added if required.



1 3/4" Flush Mount Aircraft Filler Cap

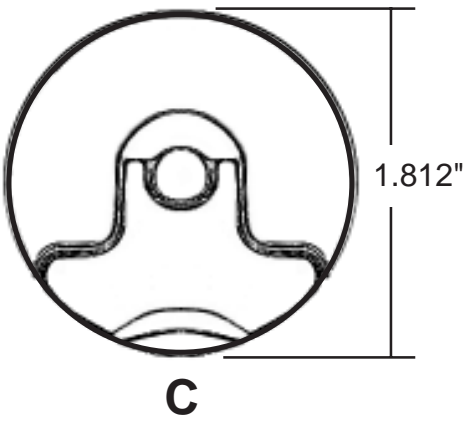
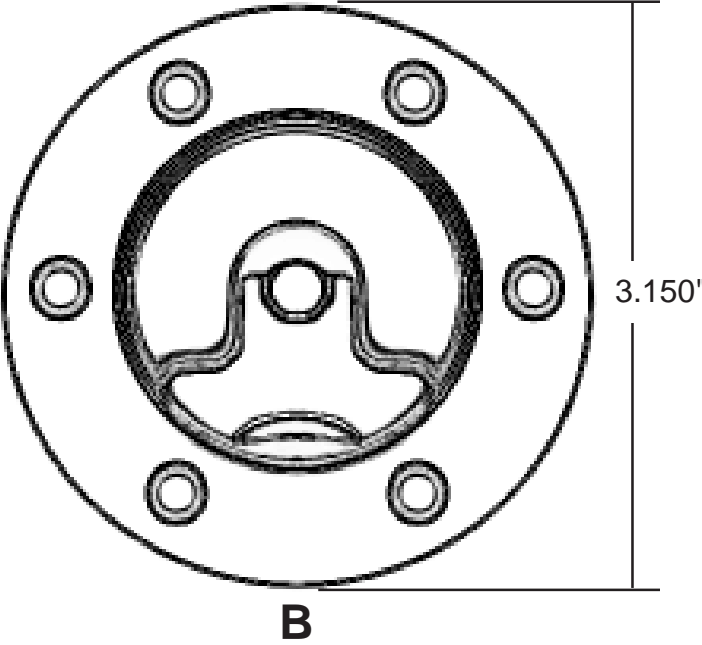
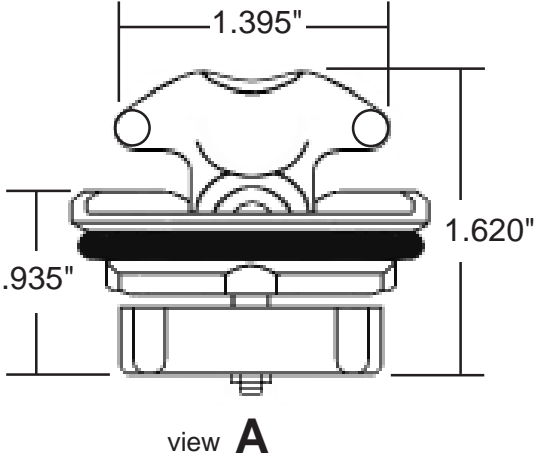

fuel resistant
sealing o-ring

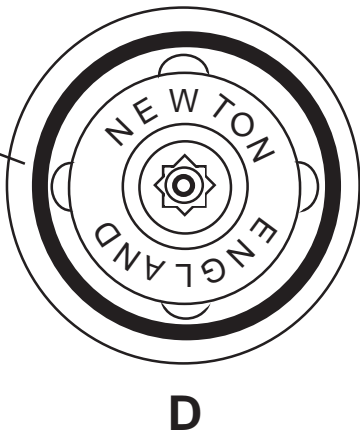

1 3/4" Aircraft Filler Cap	
A:	Filler Cap (side view) tab up
B:	Filler Cap & Flange (top view)
C:	Filler Cap (top view) tab down
D:	Filler Cap (bottom view)
approximate scale 1:1	

Mounting Flanges for 1 3/4" Filler Cap

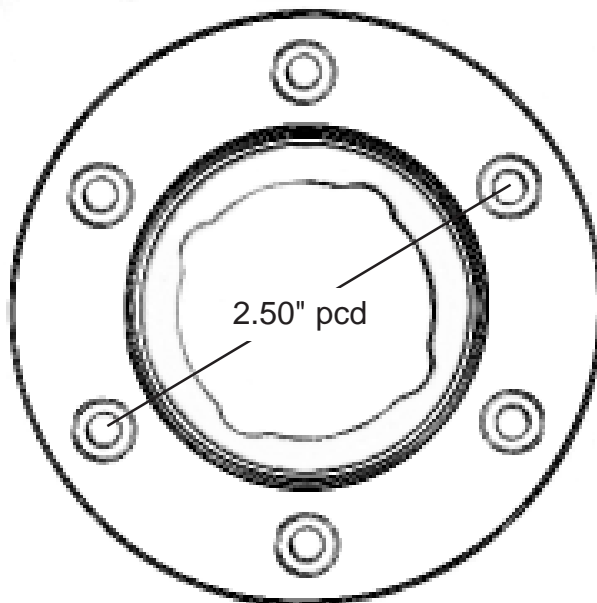

view **E**

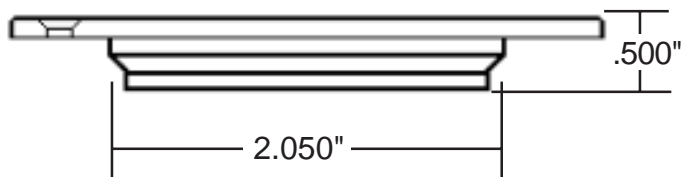

F

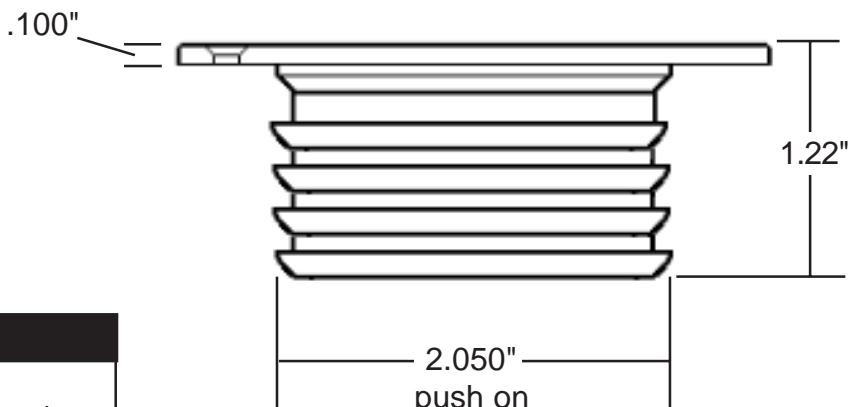

G

1 3/4" Filler Cap Flanges

E: Mounting Flange (top view)
same for flush & direct to hose versions

F: Mounting Flange (side view)
flush mount type

G: 2 1/4" Mounting Flange (side view)
direct to 2" hose push on

approximate scale 1:1

2 1/4" Flush Mount Aircraft Filler Cap

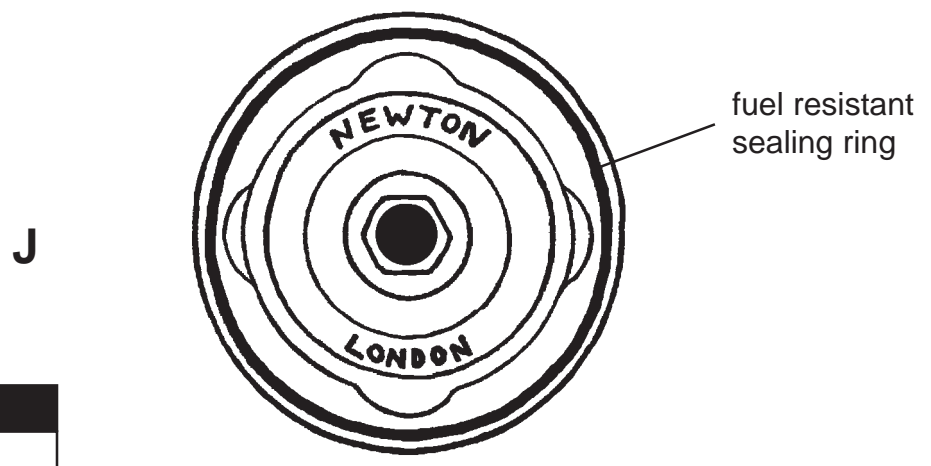
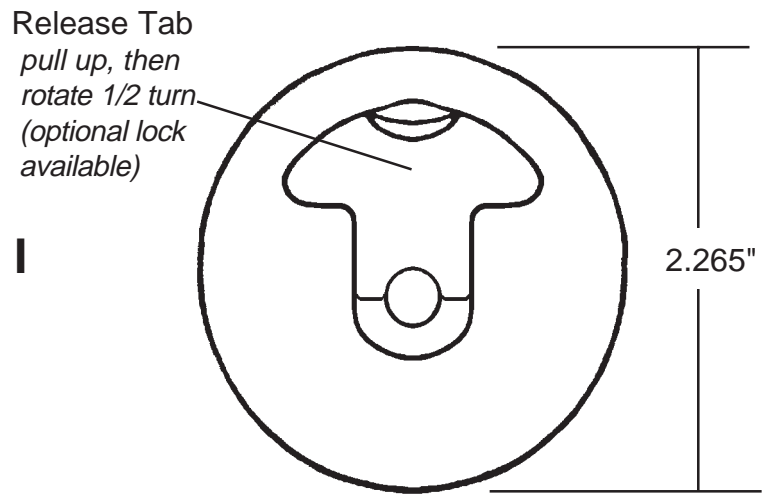
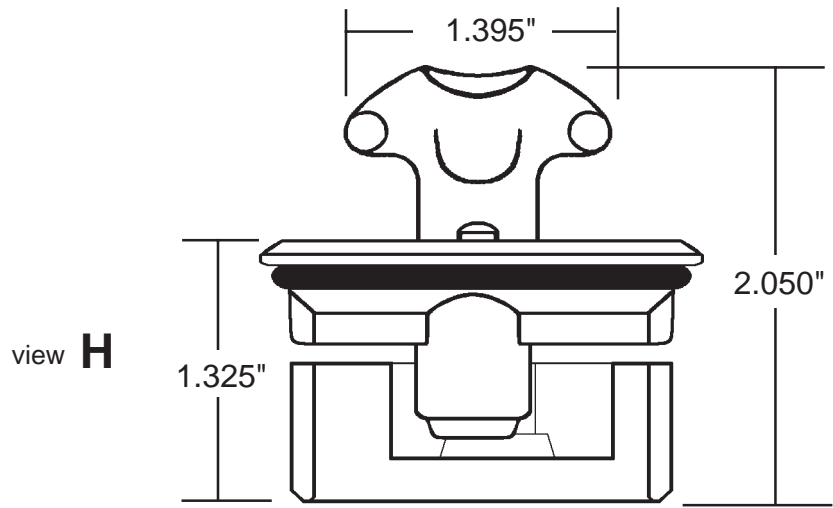

2 1/4" Aircraft Filler Cap
H: 2 1/4" Filler Cap (side view) <i>note: optional lock</i>
I: 2 1/4" Filler Cap (top view) <i>note: locking tab (down)</i>
J: 2 1/4" Filler Cap (bottom view)
approximate scale 1:1

MOCAL

view **K**

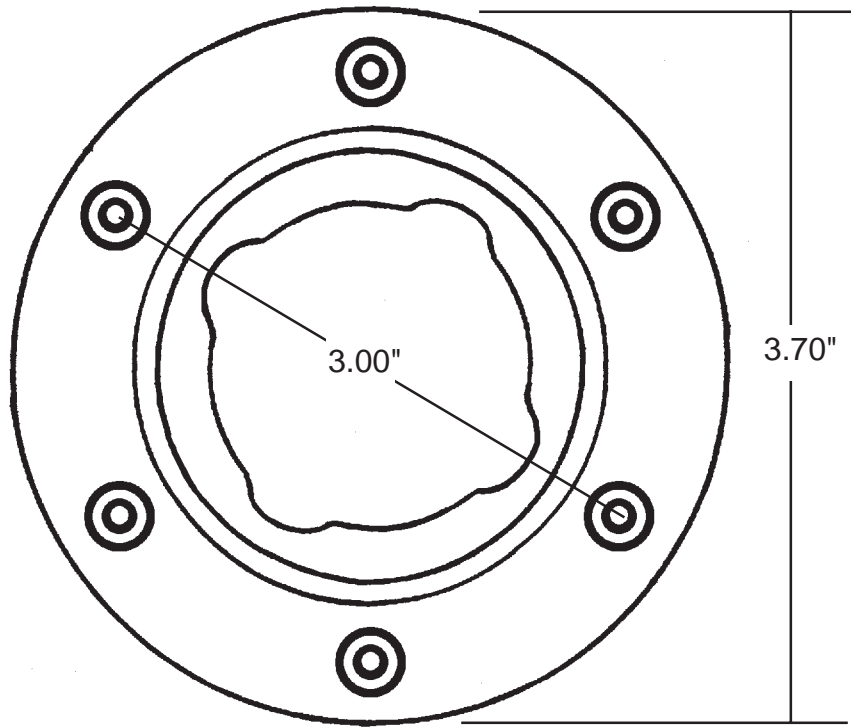

L

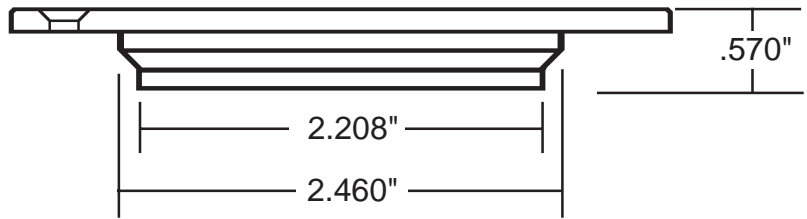

.115"

M

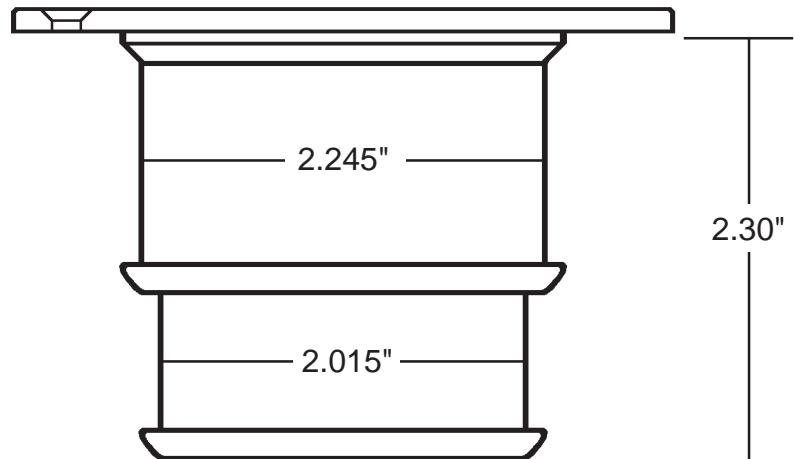

2 1/4" Filler Cap Flanges

K: 2 1/4" Mounting Flange (top view)
same for flush & direct to hose versions

L: 2 1/4" Mounting Flange (side view)
flush mount type

M: 2 1/4" Mounting Flange (side view)
direct to 2" or 2 1/4" hose

approximate scale 1:1

3" Flush Mount Aircraft Filler Cap

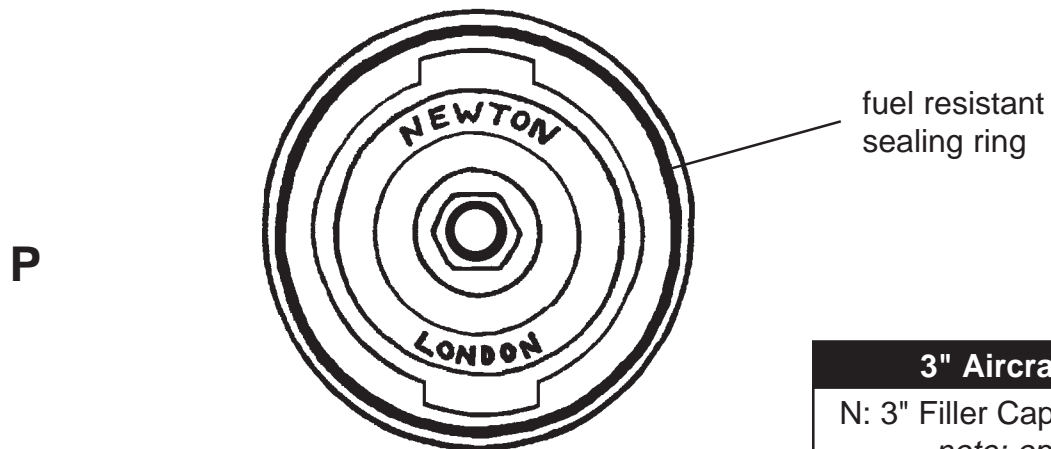
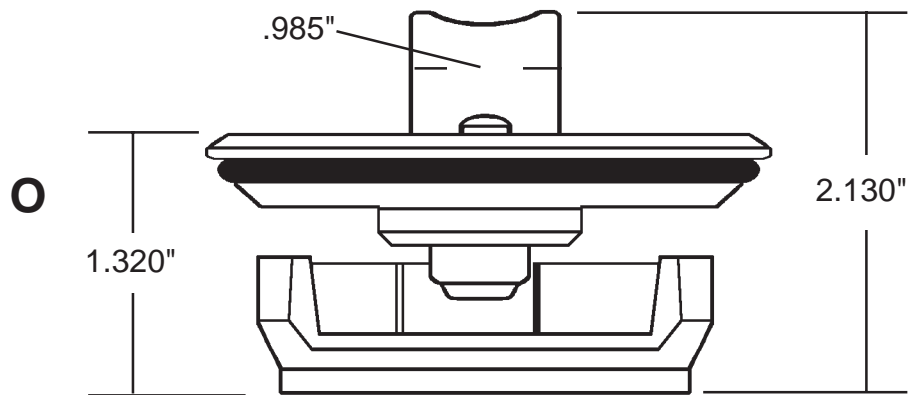
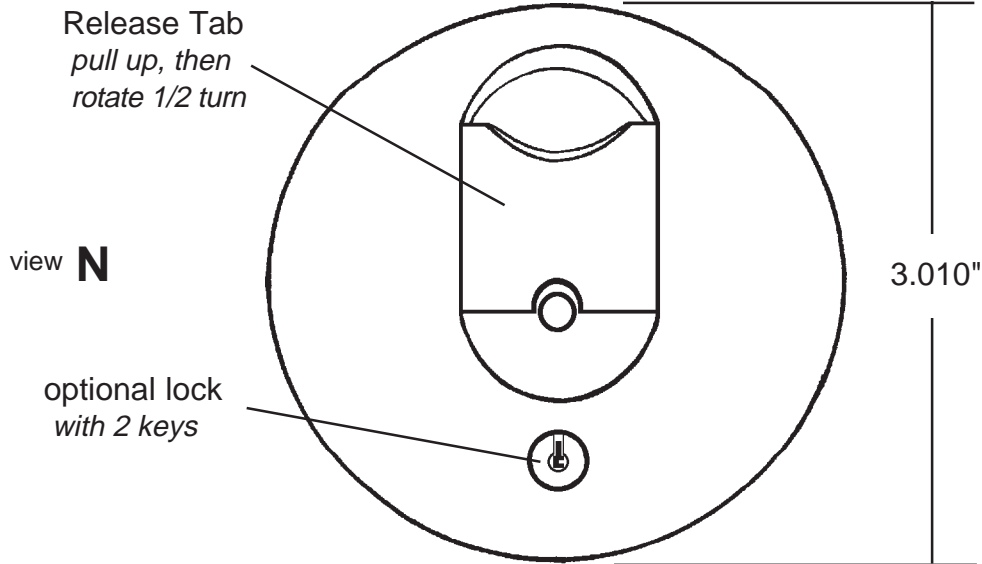

3" Aircraft Filler Cap

N: 3" Filler Cap (top view)
note: optional lock

O: 3" Filler Cap (side view)
note: locking tab (up)

P: 3" Filler Cap (bottom view)

approximate scale 1:1

Flush Mounting Flange For 3" Cap

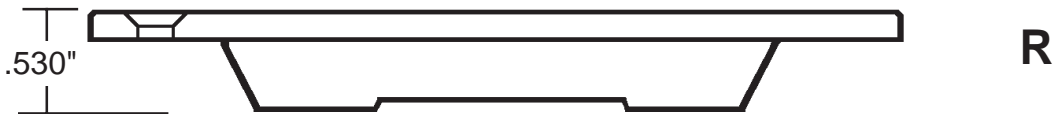
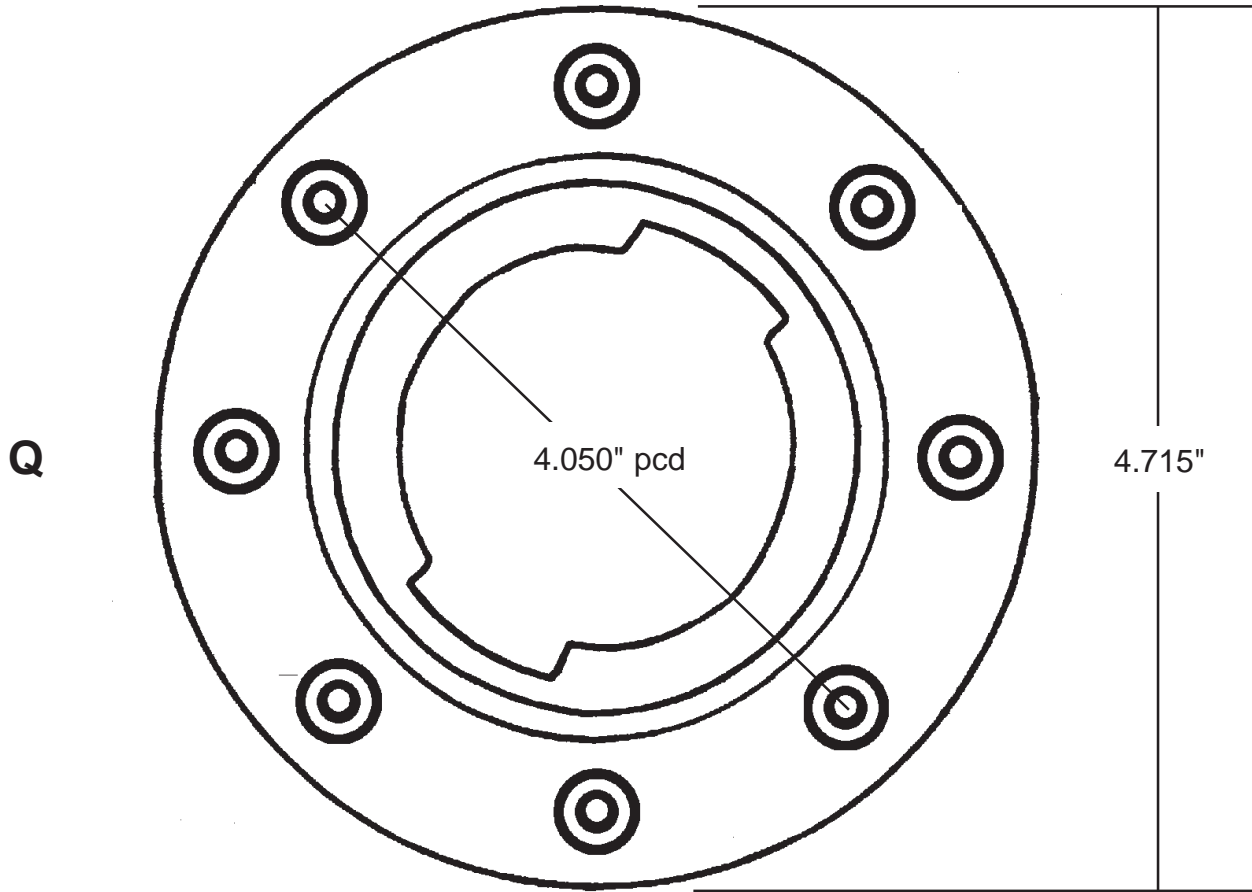

3" Flush Mounting Flange

Q: 3" Flush Mounting Flange (top view)

R: 3" Flush Mounting Flange (side view)

MOCAL

view **S**

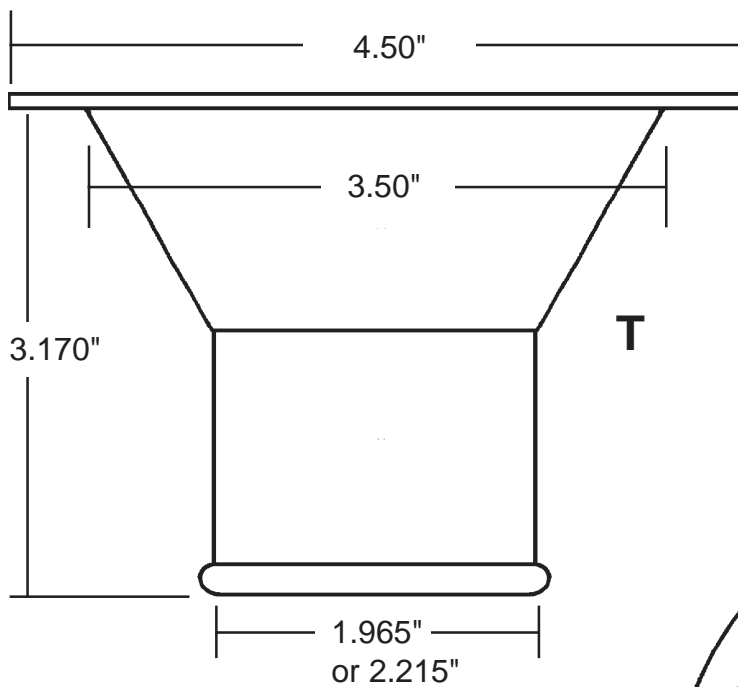
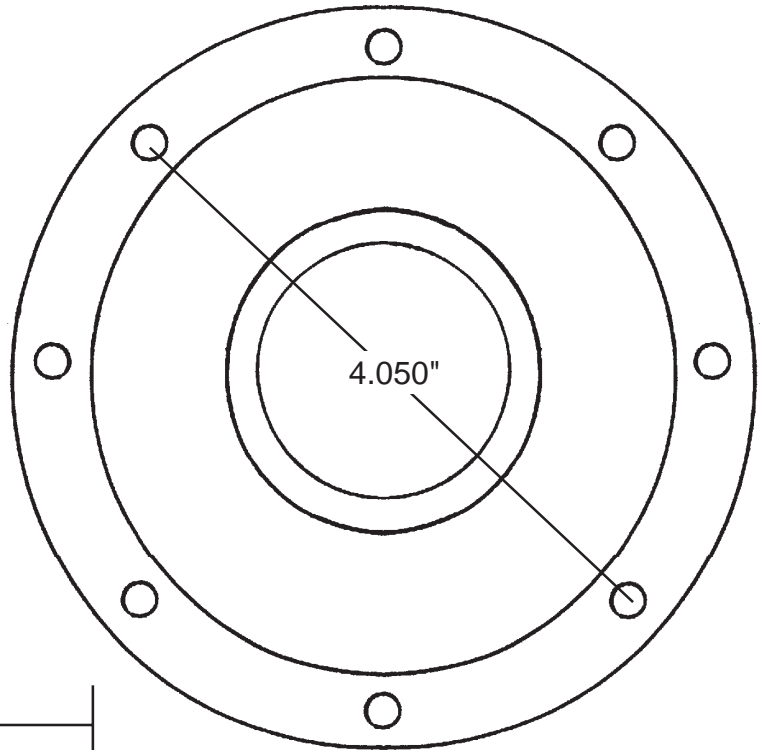

T

U

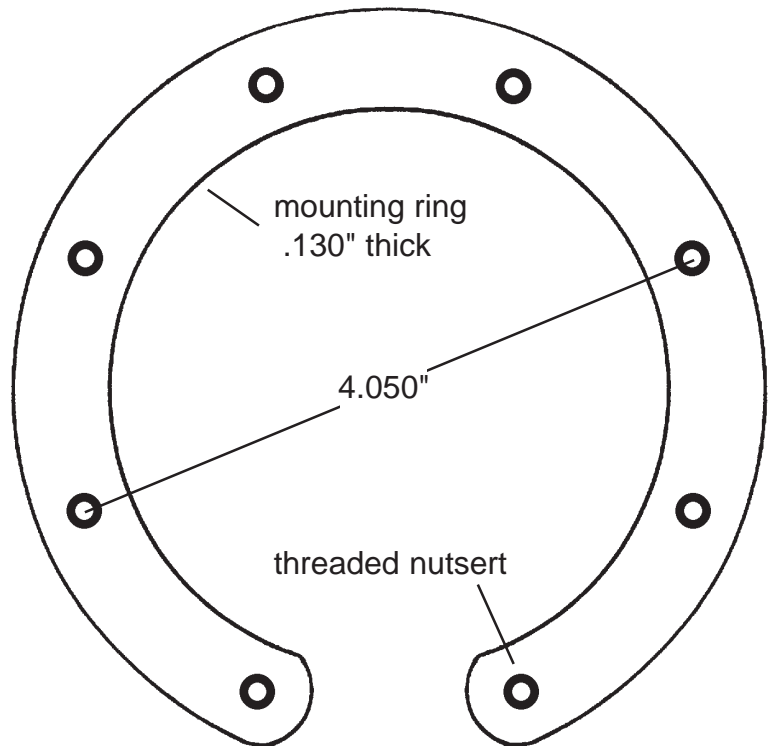

3" Cap Funnel Neck & Nut Ring

S: 3" Funnel Neck (top view)

T: 3" Funnel Neck (side view)
available in either 2" or 2 1/4" hose size

U: 3" Mounting Ring w/threaded nutserts

approximate scale 1:1

4" Flush Mount Aircraft Filler Cap

view **V**

optional lock
with 2 keys

Release Ring
pull up, then
rotate 1/2 turn

3.90"

Dual
Oring
Seals

W

1.85"

3.45"

Glass Filled
Nylon Base

4" Filler Cap Mounting Flanges

V: 4" Fuel Cap (top view)

W: 4" Fuel Cap (side view)
with locking ring up

approximate scale 1:1

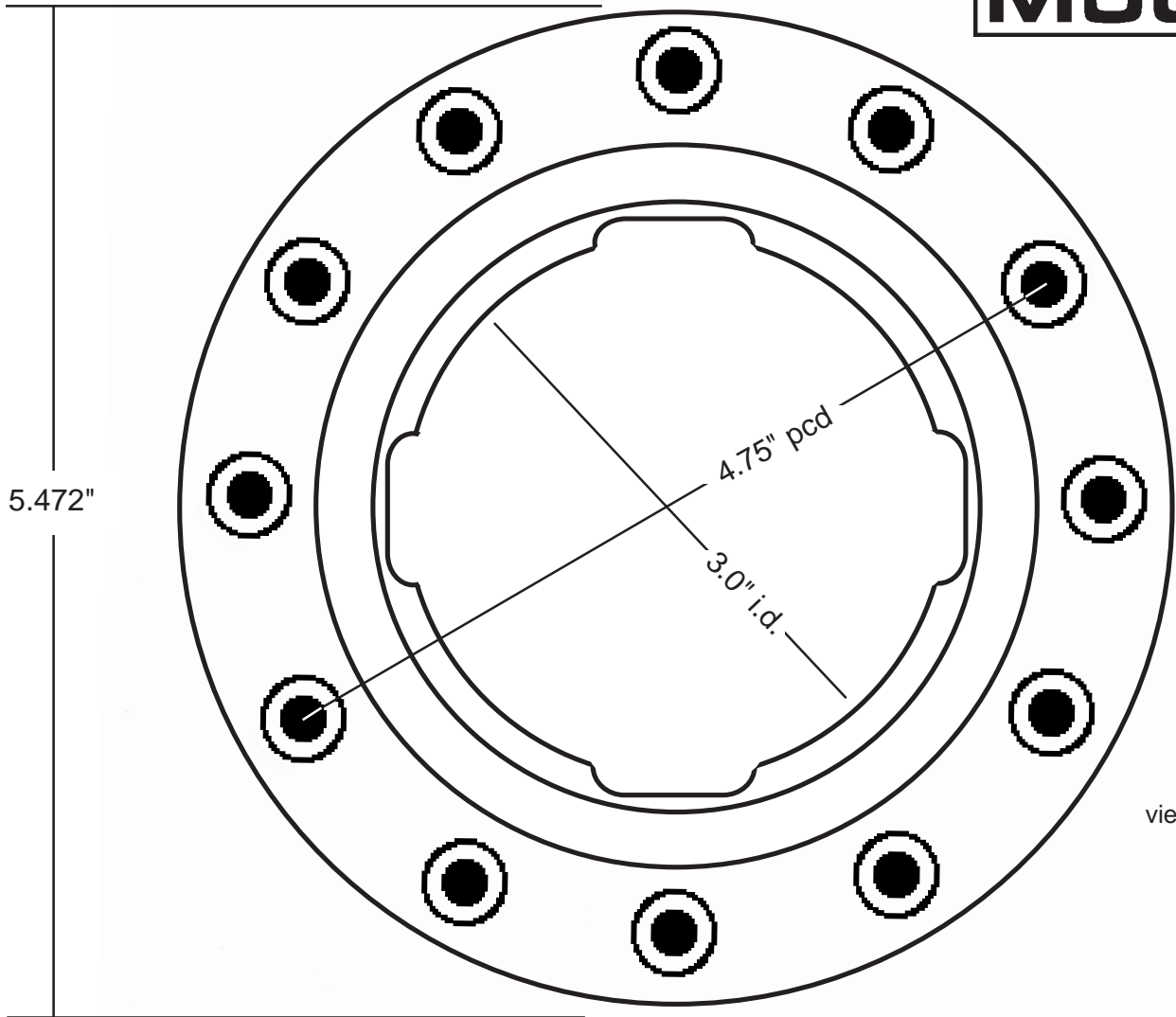

view X

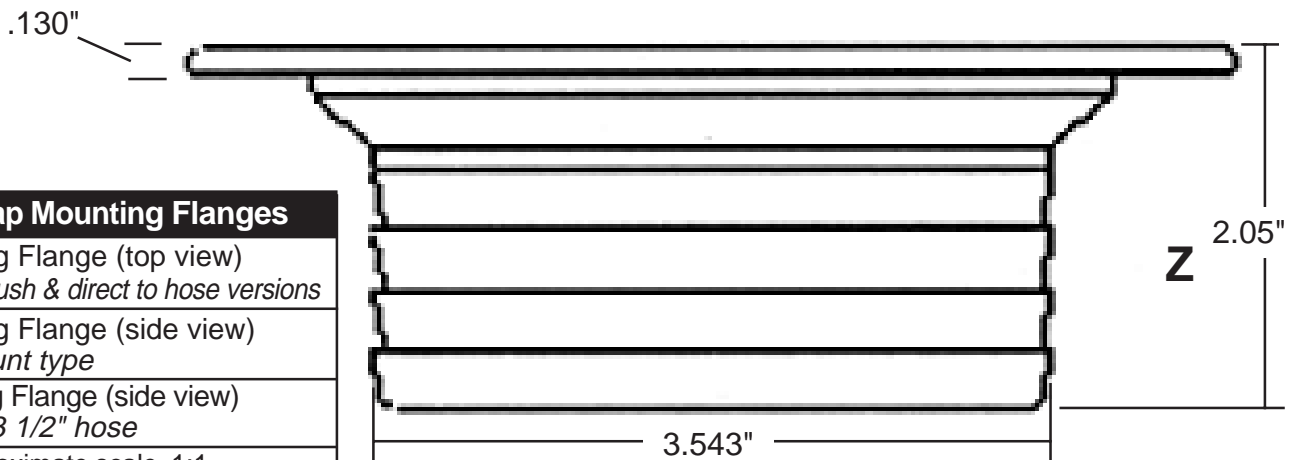
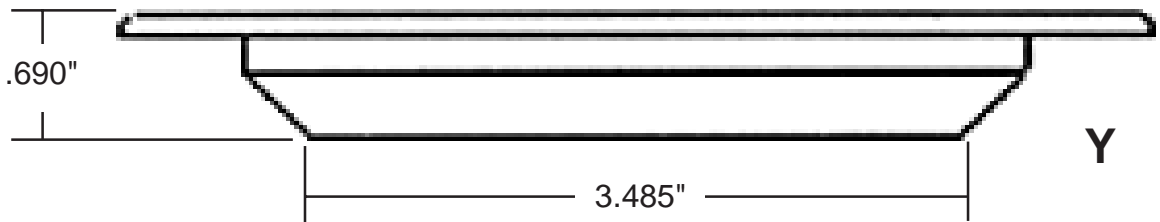

4" Filler Cap Mounting Flanges

X: Mounting Flange (top view)
same for flush & direct to hose versions

Y: Mounting Flange (side view)
flush mount type

Z: Mounting Flange (side view)
direct to 3 1/2" hose

approximate scale 1:1

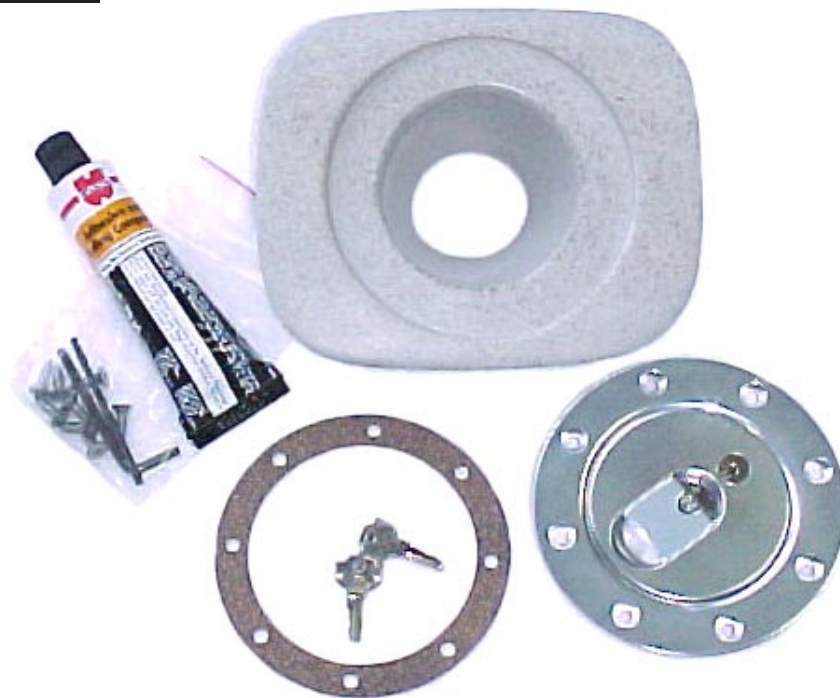

Installation Kits

Fitting a Aero cap has not always been an easy or inexpensive task until now. Our new custom Aero Cap Installation Kits make fitting a snap. Kits are designed to fit the Aero 400 (3") cap to many current popular vehicle applications (see below listing). The key to the kit is a specially designed composite (plug) which fits in the filler neck area and facilitates flush mounting of the flange and cap portion of the assembly. Kits include the Aero 400 (3") locking cap, mounting hardware, seal, adhesive, and composite plug which can be painted to match vehicle color.

<u>MAKE</u>	<u>MODEL</u>	<u>KIT#</u>	<u>Price</u>
Audi	A4	KCA007	\$219.50
BMW	3 Series (E30)	KCA009	\$219.50
	3 Series (E36)	KCA010	\$219.50
Honda	Civic	KCA033	\$219.50
Subaru	Impreza	KCA070	\$219.50
VW	Golf 2	KCA066	\$219.50
	Golf 3 (3 door)	KCA067	\$219.50
	Golf 4	KCA068	\$219.50
	Beetle B5	KCA063	\$219.50

Note: We will be continually adding new applications, call with requests.

Fuel Filler Caps

Caps are constructed from aluminum forgings or solid billets, the material is either 6063 or 6082. Saddle clamps are glass filled nylon (except A200 which is 6082 aluminum). All aluminum parts are clear anodised. Center pins, springs, operating levers, mounting screws & nuts are stainless steel. Rubber seals are fluorosilicone BS1806 standard.

Racer Pricing



Aero 200 Cap
 cap: 1.75"
 cap material: 6063 Aluminum
 flange material: 6082T6
 flange bolt circle: 2.5" PCD
 fixing holes: 6 x 4mm
 mounting: flush flange (direct)
 hose flange 2.0"(remote mount)
 versions: non-locking only

Aero 200 (1 3/4" Aircraft Filler Cap- for direct mounting)

includes: filler cap (see drawing A,C,D) and flush mounting flange (see drawing E,F). Lock feature not available in this size

standard cap & flange CAP1 \$75.50

Aero 200 (1 3/4" Aircraft Filler Cap- for remote mounting)

includes: filler cap (see drawing A,C,D) and flush mounting flange (see drawing E,G). Lock feature not available in this size

standard cap & flange CAP1F \$92.00



Aero 300 Cap
 cap: 2.25"
 cap material: 6063 Aluminum
 flange material: 6082T6
 flange bolt circle: 3.0" PCD
 fixing holes: 6 x 5mm
 mounting: flush flange (direct)
 or step flange 2.25"/2.0"(remote)
 versions: locking or non-locking

Aero 300 (2 1/4" Aircraft Filler Cap- for direct mounting)

includes: filler cap (see drawing H,I,J) and flush (direct to tank) mounting flange (see drawing K,L)

standard cap & flange CAP2 \$99.50

locking cap & flange CAP2L \$123.00

Aero 300 (2 1/4" Aircraft Filler Cap for remote mounting)

includes: filler cap (see drawing H,I,J) and integral funnel stepped flange for either 2 1/4" or 2" hose (see drawing K,M)

standard cap & step flange CAP2F \$122.50

locking cap & step flange CAP2LF \$145.00



Aero 400 Cap
 cap: 3.0"
 cap material: 6063 Aluminum
 flange material: 6082T6
 flange bolt circle: 4.0" PCD
 fixing holes: 8 x 5mm
 mounting: flush flange (direct)
 or for (remote) mounting use
 funnel/neck 2" or 2.25" hose
 versions: locking or non-locking

Aero 400 (3" Aircraft Filler Cap- for direct mounting)

includes: filler cap (see drawing N,O,P) and flush (direct to tank) mounting flange (see drawing Q,R) use with FUN1/2 for remote mounting

standard cap & flange CAP3 \$105.00

locking cap & flange CAP3L \$123.25

Aero 300 & 400 Cap Mounting Accessories

Aero 400 Funnel Neck & Gasket for 2" hose (drawing S,T)
(drawing L,M) allows for remote mounting **FUN1 \$32.00**

Aero 400 Funnel Neck & Gasket for 2 1/4" hose (drawing S,T)
(drawing L,M) allows for remote mounting **FUN2 \$32.00**

Aero 400 Mounting Ring 4" PCD 8 hole
with captive nuts (drawing U) **RIN1 \$18.50**

Aero 300 Mounting Ring 3" PCD 6 hole
with captive nuts **RIN2 \$16.25**

Aero 400 Rubber Base Gasket **RUB1 \$12.00**

Aero 400 Rubber Spill Tray (w/drain) **RUB2 \$31.50**

Small Vent Valve **TBV45 \$25.50**



Fuel Filler Caps

Caps are constructed from aluminum forgings or solid billets, the material is either 6063 or 6082. Saddle clamps are glass filled nylon (except A200 which is 6082 aluminum). All aluminum parts are clear anodised. Center pins, springs, operating levers, mounting screws & nuts are stainless steel. Rubber seals are fluorosilicone BS1806 standard.

Racer Pricing



Aero 500 Cap
 cap: 4.0"
 cap material: 6063 Aluminum
 flange material: 6082T6
 flange bolt circle: 4.75" PCD
 fixing holes: 12 x 5mm
 mounting: flush flange (direct)
 or for (remote) mounting use
 funnel/neck 3.5" hose
 versions: locking or non-locking

Aero 500 (4" Aircraft Filler Cap- for direct mounting)

includes: filler cap (see drawing V,W) and flush (direct to tank) mounting flange (see drawing X,Y)

standard cap & flange	CAP500	\$132.50
locking cap & flange	CAP500L	\$155.00

Aero 500 (4" Aircraft Filler Cap for remote mounting)

includes: filler cap (see drawing V,W) and integral funnel flange for push on 3.5" hose (see drawing X,Z)

standard cap & flange for p/o hose	CAP500F	\$154.00
locking cap & flange for p/o hose	CAP500LF	\$175.00

Fuel Hose & Elbows

Hose 2" (51mm) i.d.	NH51	\$21.00 (ft)
Hose 2.25" (57mm) i.d. w/steel ground	NH57	\$34.25 (ft)
Hose 2.5" (63mm)	NH57	\$34.25 (ft)
45 elbow 2" (51mm) i.d.	NH451	\$37.50
90 elbow 2" (51mm) i.d.	NH951	\$37.50

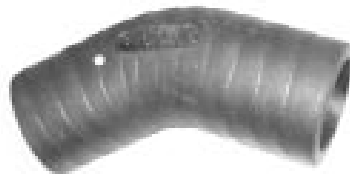

NH451



NH951